

MADRAS SCHOOL OF ECONOMICS
at Gandhi Mandapam Road, Chennai - 600 025.

Additional Civil works

1. Director Room Toilet
2. Ramp Work
3. Rainwater Harvesting Work
4. Water Proofing Work At Old Library Building Terrace
5. Miscellaneous Works

					24.04.2026
SLNO	DESCRIPTION OF WORK	UNIT	QUANTITY	RATE	AMOUNT
A	RAMP WORK (7 Different places)				
I	EARTHWORK EXCAVATION				
1	Excavate foundation in all kinds of soil including soft rock(except hard rock requiring blasting) part return and fill in foundation and basement in layers not exceeding 15cm in depth including watering, breaking clods and consolidating, and disposal of surplus earth away from the site upto 1.5m depth (No extra shall be payable for working space) Rate Should include cost of back filling	cu.m	7.00		-
2	Same as above but for 1.5m to 3m deep	cu.m	QRO		
3	Supplying and filling inside basement under floors with M.Sand in layers of not exceeding 300mm thick including watering and consolidating all complete as directed.	cu.m	6.00		-
4	Supplying, laying, Spreading and consolidation of pit sand / earth as per relevant indian standards where ever required in layers not exceeding 200mm depth including breaking clods, storing, transportation, double handling, watering, compacting, each layer with 8-10 ton vibro roller to achieve 90 - 95 % proctor density of optimum moisture content, all leads and lifts, bailing / plumbing out of water to keep site dry while back filling. cost shall be include conveyance of all materials, labour, machinery, etc. complete as directed.the rate to include loadin, unloading hire and fuel charges fpr tools and plants and other incidental charges etc complete	cu.m	15.00		-
5	Same as above but Earth available at site	cu.m	QRO		
II	PLAIN CEMENT CONCRETE				
6	Cement concrete 1:4:8(1 cement, 4 sand,8 hard blue granite stone metal 40mm and down gauge) in layers not exceeding 15cms in depth well consolidated in levelling course under floors including ecessary shuttering of required profile all complete as directed.	cu.m	6.00		-

III	REINFORCEMENT CEMENT CONCRETE				
7	RCC M30(design mix) using hard blue granite metal 20mm and down gauge including centering, shuttering, curing etc. complete but excluding cost of reinforcement. Minium cement content should be 360 kg/cu.m.				
7.1	Ramp	cu.m	5.00		-
7.2	Reinforcement steel	MT	1.3		-
IV	FLOORING				
8	Supply and laying of 300x300mm size Anti-skid terracotta tile . Basic price -55 rs/sqft.	Sqm	35		-
V	BRICK WORKS & FINISHING				
9	230MM THK BRICK WORK	Cu.m	3		-
10	Plastering 1:5	Sqm	20		-
	RAMP WORK SUMMARY				-
B	RAINWATER HARVESTING WORK				
9.1	Towards construction of recharge well of 4 feet in diameter and 15 feet in depth and provided with PCC rings. Cost inclusive of labour for well digging, casting of PCC rings @ Rs. 1,800 per foot				
	Cost of providing 3 ins. thick 4 feet diameter RCC lid (material plus labour) with perforated manhole cover				
	Transport of rings to site				
	Removal of excavated soil from site				
	Cost of 4 ft Recharge well	Each	3		-
9.2	Towards interconnection of rooftop pipes and leading it to the recharge well 15M of 4 inches dia pipe.	RM	15		-
9.3	Towards cost of Construction of chamber with lid .	Each	3		-
	RAINWATER HARVESTING WORK SUMMARY				-

C	WATER PROOFING WORK AT OLD LIBRARY BUILDING TERRACE				
1	<p>Specifications:</p> <p>1. Roof terrace floor and walls surface cleaning with water and wire brush scrubber, Groove cutting if crack is more than 2mm and groove filling with SIKA SBR 2 ratio 1:1:2. Chemical: water: cement.</p> <p>2. First coat roof terrace SIKA SBR 2 ratio 1:3:4 chemical water cement applies by broom</p> <p>3. Second coat SIKA SBR 2 chemical coating with fiber mesh 45 gsm each coat duration of minimum four hours. Second coat ratio 1:2:3 and third coat with ratio 1:2:3.</p> <p>Roof terrace Fosroc Roof guard Elastomeric Coating</p> <p>1. It is a heavy-duty terrace waterproofing coating system, composed of specialty developed highly elastic and resilient acrylic polymers, properly selected and grade fitters.</p> <p>2. It is a three-layer system with coat in terracotta coat red color ensuring proper buildup of the thickness. Making it is a reliable waterproofing system.</p> <p>3. Provide higher dry film thickness of 800 micron to 1mm in one coat primer and two coat application.</p> <p>4. No need to remove existing sound brick bat coba plaster or weathering tile concrete surface.</p> <p>5. Higher tensile strength, tear resistance and bond strength with cementitious substrate resident to UV and whether condition.</p> <p>6. Can be applied by brush and roller easily.</p> <p>7. Nontoxic in nature</p> <p>8. Bridges cracks up to 2mm width</p> <p>9. Application: generally used in over existing cementitious.</p> <p>Waterproofing treatment like brick bat coba, concrete screed, acrylic coating etc. Also used in</p>	Sq.m	215		-
	WATER PROOFING WORK AT OLD LIBRARY BUILDING TERRACE SUMMARY				-
E	MISCELLANEOUS WORKS				
1	In Between Admin block and Main building pathway portion 3" core cutting	Each	4		-
	MISCELLANEOUS WORKS SUMMARY				-
F	DIRECTOR ROOM TOILET				
1	Dismantling existing Brick work and disposing the debris	Cum	1.50		-
2	Dismantling existing wall tile and disposing the debris	Sqm	11.50		-

3	Half Brickwork with locally available Fly ash Bricks of size 230x110x70mm containing the Ash content upto 60% by weight of bricks and conforming to IS code 12894. The brick should comprise of uniform shape with frog and the Compressive strenght should not be less than 40Kg/sq.cm (40kg/sq.cm to 100Kg/sq.cm) in Cement mortar 1:4 (1 cement, 4 sand) and and reinforced with two numbers of 6mm dia.M.S rods at every fourth course embedded in cement mortar 1:4 for partitions.	Sqm	7.00		-
4	Prepare surfaces and plaster with C.M 1:5(1 cement,5 M sand) ,12mm minimum thick to all interior faces of walls (smooth finish) including RCC surfaces not contiguous to masonry.Rate should include the cost of providing necessary internal grooves of size 10mmx10mm carried out as shown/directed by Engineer-in-charge. Quantum of grooves may vary from Tender drawings to actually executing at site. Note : All RCC and masonry junction shall be provided with 24 gauge chicken mesh of 6"width for the entire joining length before commencement of plastering at all levels. No extra shall be payable on this account	Sqm	15.00		-
5	Brick jelly cement concrete 1:4:8 using approved broken brick jelly 25mm and down gauge laid in sunken floors at all levels.	Cum	0.75		-
6	Water proofing in sunken slab as per India/South India water proofing or equivalent all as per manufacturer's specifications at all levels.	Sqm	5.50		-

7	Cement concrete 1:3:6 (1 cement, 3 sand, 6 hard blue granite stone metal 20mm and down gauge) in layers not exceeding 15cms in depth well consolidated in levelling course under floors including necessary shuttering of required profile all complete as directed.	cu.m	0.20		-
8	Prepare surfaces and paint with two coats of plastic emulsion paint of approved colour over two coats of JK White Cement putty and primer all complete as per manufacturer's specifications to all interior faces of walls, etc in all floors.	sq.m	18.50		-
9	Supplying and fixing WPC Door Frame along with WPC Door 30mm thick shutter. including cost of hardwares and all labour for fixing complete.	sq.m	1.58		-
10	Providing and laying 300mmx600mm Granamite tile from Kajaria/Asian/ omani/Johnson/NITCO or equivalent glazed tiles of approved colour in dado set in C.M 1:3 with joints so as to form a true and even surface and joints finished neatly with white cement mixed with matching pigments all complete as directed.(Rate should include base plastering with C.M 1:5 of required thickness.) Rate should also include cost for providing and fixing of Dural corner beads for glazed tiles of approved colour at all corners. (Tenderer to submit pamphlets showing the item quoted before executing the work) at all levels Basic Price shall be of Rs 60.00 per sft.	sq.m	16.00		-
11	Providing & laying first class vitrified ceramic tile of size 300mmx300mmx8mm of approved make & colour in flooring over a bed of cement mortar 1:4 of minimum thickness 20mm jointed with white cement slurry mixed with matching pigments all complete as directed. at all levels. Basic Price shall be of Rs 60.00 per sft.	sq.m	3.25		-

12	Supplying, transporting to Site, Unloading ,Safe storage,installing,testing and commissioning of approved make white color Wall mounted European Water closet - with 'P' trap , soft close seat cover, Hinges, Accessories Set, pan connector, silicon sealant etc. complete. Cost including conveyance of all materials to the site, all labour charges etc., complete. Works including cutting and making rough finishing the walls and floors wherever required, checked by the site engineer. All works done as per the drawing as directed by site engineer.				
	Roca-GAP Square Rimless White colour Wall hung Wc with Gap Square Soft Closing Seat Cover with fixing accessories, Model No:- RS34647L460 + RE801472464 (seat cover), Size: 350X540X345mm.				
	Accessories Set which includes C.I chair bracket/Rag bolt/Fisher bolt				
	WC outlet connector/Pan connector	Set	1.00		-
13	Supplying, installing, testing and commissioning of Wall hung Rectangular Wash basin with 15mm Pressmatic tap,32mm dia waste coupling, 32mm dia bottle trap with extension pipe,15mm cp angular stop cock with wall flange, with connection tube including necessary supporting brackets, with screws or bolts etc complete. Cost including conveyance of all materials to the site, all labour charges etc., complete. Works including necessary cutting and making finishing the wall and floors wherever required etc. complete.				
	Wall hung Rectangular Wash basin without pedestal -Parryware-Sutra-Model No: C041X,Size: 510 x 400 x 175 mm				
	Waste coupling- Jaquar - ALD-705				
	Bottle trap - Jaquar - ALD-769L300x190				
	Pressmatic taps - Jaquar -PRS- 031-G				
	Schell make-TRIOS regulating angle valve; Surface: chrome, Packaging unit: 1, G 1/2 x G 1/2-Model No: 05 451 06 64				
	Rag bolt/Fisher Bolt/Wall basin brackets with screws or bolts				
	450mm long braided hose with M10X1 nipple, 15mm nut, O-ring & rubber washer - Jaquar - ALD-803AB	Set	1.00		-

14	Internal plumbing Works				
a	Fabricating, supplying, and fixing of 4mm thickness fabricated uPVC Floor traps , made out of 110mm dia PVC Pipe with single or multiple inlets of size 40mm to 75mm dia.(boss tee), as per the following specification.				
	Material: uPVC Floor trap				
	Thickness of FD : 4mm				
	Application: Drainage (Sunken & Suspended)				
	Water seal :50mm min				
	Water seal :Single/Multiple				
	Marking, chasing, laying testing, concealing & commissioning the floor traps				
	Installation: As per the consultant approved drawing.	No	2.00		-
b	Supplying and fixing of Heavy duty SS anti cockroach grating of approved make, fixed over the floor trap as per the specification.				
	Material: SS - Heavy duty				
	Size: 150 X 150 mm Square floor plate with inlet removable grate.				
	Duty: Heavy duty cover suitable for uPVC Floor trap				
	Marking,fixing, testing, commissioning and filling the caps around the grating				
	Installation: As per the consultant approved drawing.	Each	2.00		-
c	Supplying,fixing and testing of approved make Internal water supply pipe with CPVC pipes and CPVC Fittings as per the following specifications.				
	Pipe : CPVC - SDR 11 conforming to IS.15778.2007				
	Fittings: CPVC - SDR 11 conforming to IS.15778.2007				
	Jointing method : With pipe cleaner & CPVC Solvent cement				
	Application: Domestic and Potable Water supply -Pipes running above the false ceiling and embedded on the walls, and stacked vertically. (Concealed/Suspended/Riser/Buried)				
	Marking, chasing, laying with proper support, testing, commissioning and concealing the pipe				

	Support: G.I Anchor fastner, G.I threaded rod, rubber lined split clamps as suitable pipe size and G.I 'U' bolts with nut and washer. Anchor fastener shall be selected for a cracked conditions. Split clamps shall be used in the horizontal running pipe and rigid support shall be provided with G.I channel at every 4.0 ft intervals and every change of directions. Doing disinfection for all the main pipes and providing ID lables for all the plumbing services.				
	Test: Hydraulic pressre test (test pressure shall be 1.5 times of working pressure)				
	Installation: As per the consultant approved drawing.				
	3/4"dia (NB)/20mm-SDR-11	RM	5.00		-
d	Supplying, fixing and testing of approved make SWR uPVC- B Class pipe for soil & waste water pipe works as per the following specification				
	Pipe : SWR PVC - B- Class confirming to IS - 13592-1992 for smaller dia.				
	Fittings: uPVC IS - 14735 with latest amendment				
	Jointing method : With Pipe cleaner & push fit type				
	Application: Draingae(Soil & waste) - Inside toilets, sunken, suspended, vertical, Under ground upto the sewage manholes & gully chambers.				
	Support: G.I Anchor fastner, G.I threaded rod, rubber lined split clamps as suitable pipe size and G.I 'U' bolts with nut and washer.Anchor fastener shall be selected for a cracked conditions. Split clamps shall be used in the horizontal running pipe and rigid support shall be provided with G.I channel at every 4.0ft intervals and every change of directions.				
	Marking, chasing, laying testing, concealing & comissioning the pipe				
	Test: Gravity leak test & Water flow test wherever required.				
	ID lables to be provided in all the pipes				
	Installation: As per the consultant approved drawing.				
	75mm dia	RM	3.00		-
	110mm dia	RM	1.50		-
e	Supplying, fixing and testing of approved make uPVC pipes and fittings for soil and waste pipe works in toilets and utility area,etc. As per the following specification.				

Pipe : uPVC 10 Kg/cm ² confirming to IS 4985-2000				
Fittings: uPVC IS 7834 with latest amendment				
Jointing method : With Pipe cleaner & Solvent cement				
Application: Draingae - Inside toilets (sunken/suspended)				
Marking, chasing, laying testing, consealing & comissioning the pipe				
Test: Gravity leak test				
Installation: As per the consultant approved drawing.				
50mm dia	RM	1.00		-
DIRECTOR ROOM TOILET WORKS SUMMARY				-
TOTAL				-
Add SGST @ 9%				-
Add CGST @ 9%				-
GRAND TOTAL				-

Name of the Employer: **MADRAS SCHOOL OF ECONOMICS, Gandhi Mandapam Road (Behind Anna Centenary Library), Kotturpuram, Chennai-600025.**

Name of the Work

Additional Civil works

- 1. Director Room Toilet**
- 2. Ramp Work**
- 3. Rainwater Harvesting Work**
- 4. Water Proofing Work At Old Library Building Terrace**
- 5. Miscellaneous Works**

IMPORTANT TERMS & CONDITIONS

1. The time allowed for the completion of is **1 months** from the 10th day after the date of written order to commence work of after the date on which the site is handed over to the contractor whichever is later.
- 2. Escalation maximum of 5% over and above basic price stated in the tender will be allowed only for cement, Reinforcement steel & vitrified Ceramic Tiles.**

Amount will be worked out on the basis of rates mentioned in original invoices submitted along with running bills & basic price stated in the tender. For escalation purpose only the theoretical quantity will be allowed.

Pl note that if there is any increase or decrease in prices of steel and cement over and above basic prices indicated in tender will be worked out and the bill will be processed suitably. **(Increase (Maximum of 5%) only will be allowed over basic price – Contractor will be compensated and if there is decrease or less in basic price the Amount to be reimbursed to the Clients.**

Basic price of materials (Excluding GST):

1. Cement – Rs 300.00 per bag
2. Reinforcement Steel (isteel)– Rs 60,000.00 per M.T
3. VCT Tile – Rs. 60.00 per Sq.ft

List of Approved of approved brands for Material.

Cement: Coromandel, Ultratech or Equivalent

Reinforcement Steel: I steel

3. Earth work Should be paid PCC area only
4. Contractors should barricade around the Proposed construction at their cost
5. Final coat of painting to be done only after completion of works.
6. Water & Power for executing this contract shall have to be arranged by the Clients,
7. For all the plastering works using M.Sand Cebex 112 “Fosroc” Make should be used for better workability without extra cost.
- 8. The site should always be kept neat & tidy.**
9. Temporary staircase should be Provided by the contractors to shift/move required construction materials and to facilitate movement of workforce/labour.

10. Safety measures are to be strictly adhered to during construction to prevent un towards accidents.

LIST OF APPROVED MAKES OF FOLLOWING MATERIALS

General Builders work :

Sl.no	Description	Approved Makes and Brand
1.	Reinforcement Steel / Structural steel	I steel
2.	Cement Ordinary Portland cement (OPC) Grade 43 Sulphate Resistant cement	Coromandel, Ultratech or Equivalent
3	P.V.C pipes	Supreme/ Prince/ Finolex or Equivalent
4.	Vitreous ceramic tiles	Kajaria/ Somany/ Johnson/ Asian/ RAK
5.	Glass	Saint Gobain or Asahi Float glass "Modiguard" or as specified
6.	UPVC windows	VEKA
7.	Hardware fittings	ECIE or Equivalent
8.	Brass Hinges	Chetna/ Janatha/Milton/HMB or Equivalent
9.	Exterior paint	Apex Ultima/ Nippon sumo Acrylic Emulsion
10.	Plastic Emulsion Interior paint	Asian/ Berger or Equivalent
11.	Cement paint	Snowcem plus or Equivalent

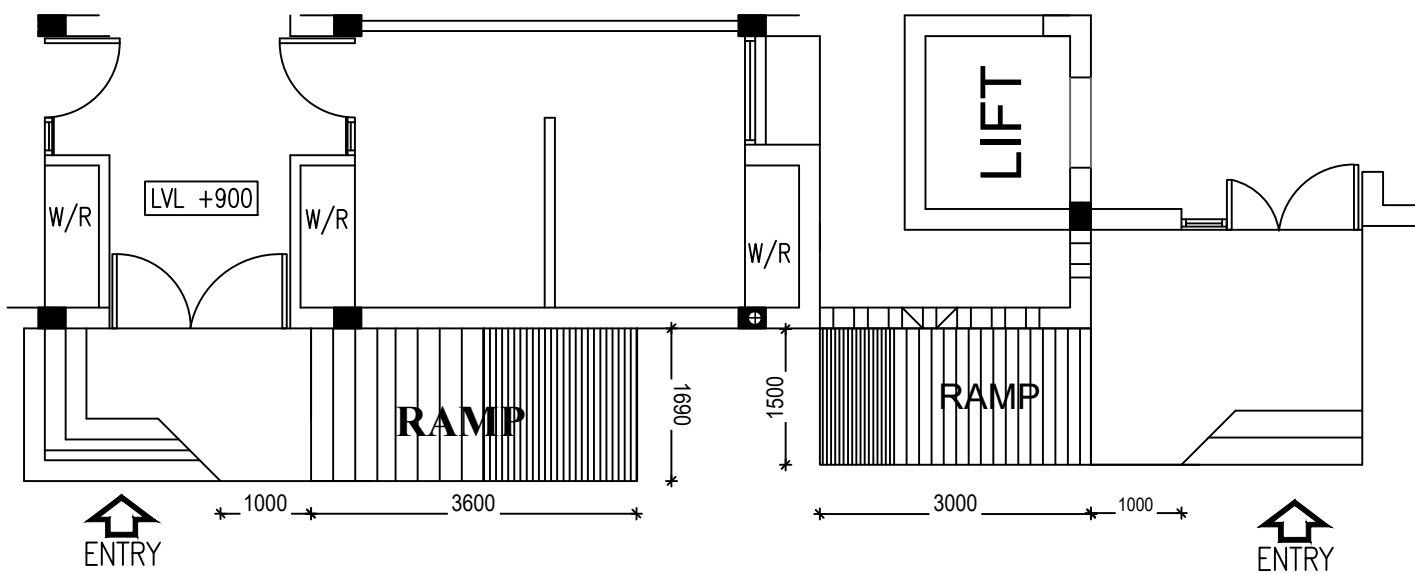

Gents Hostel & VIP Dining Ramp

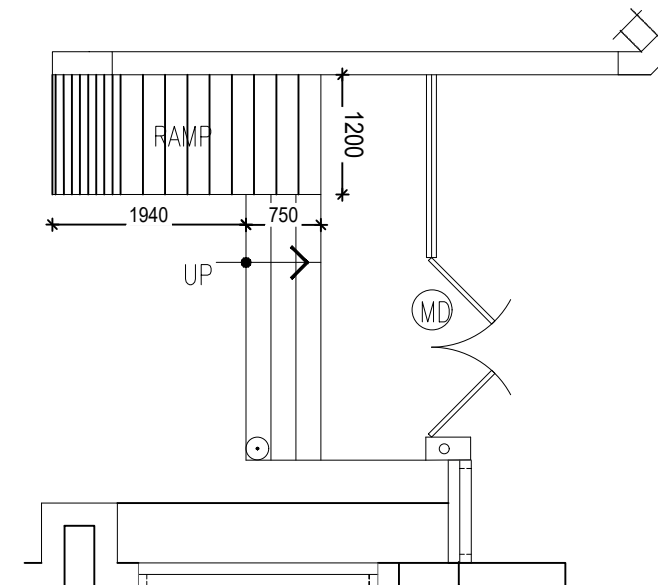

Old Library Ramp

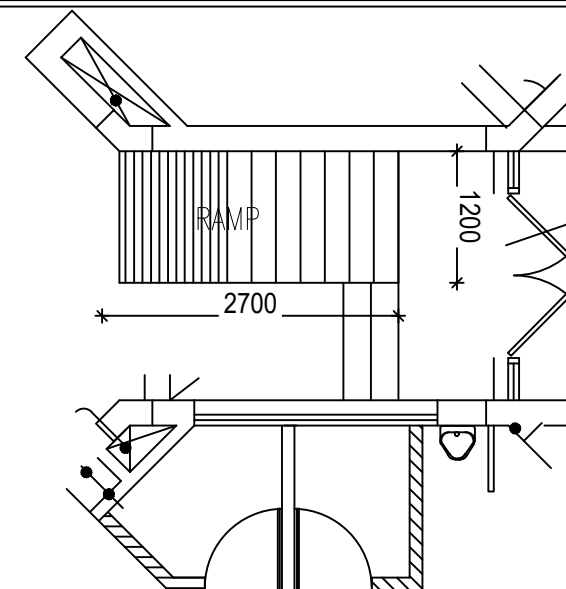

Admin Building Ramp

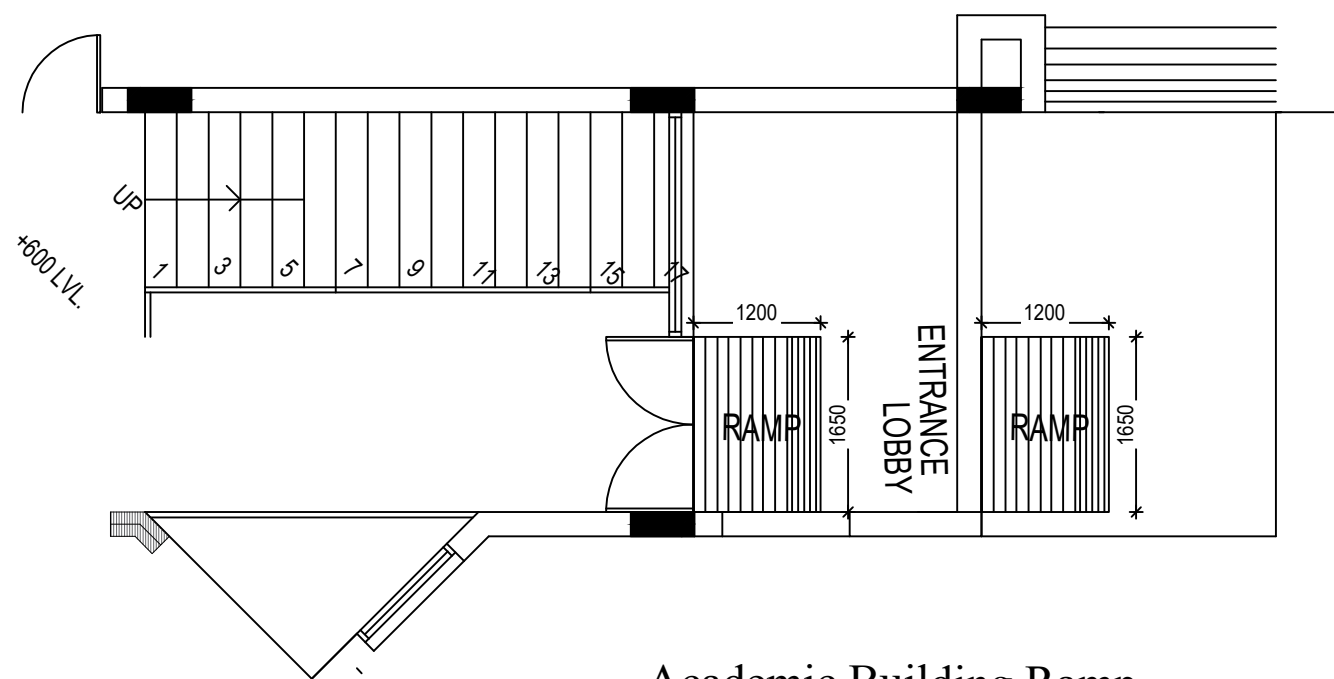

Academic Building Ramp

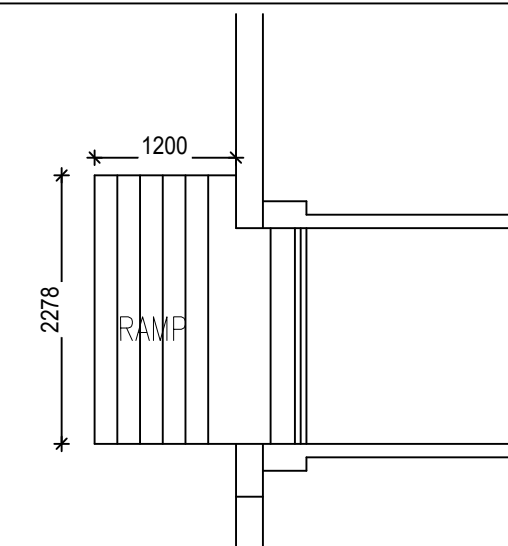

Admin Building to ACB Ramp

CC Designers

J.2, "Maxis.Presidium" New # 2, Old # 63/1, L -
Block, 24 th street, Anna Nagar East, Chennai. 600102.
ctcdesign@yahoo.com

DATE: 25.04.26

MSE RAMP DETAILS

